

BHARTIYAM RESTAURANT

TRIPTY RESTAURANT

ALL THE STANDS IN THIS HALL SHOULD HAVE ENTRY / EXIST ON ALL THE VISIBLE SIDES FACING PASSAGES & TRANSPARENCY IN THE PARTITIONS SHOULD BE MAINTAINED. THE DESIGN OF THE STAND SHALL BE GOT APPROVED FROM ARCHITECTURE DEPARTMENT BEFORE START OF THE STAND CONSTRUCTION.

9th PRINTPACK INDIA' 2009

HALL 6 (GROUND FLOOR PLAN)

JANUARY 18 - 23, 2009.

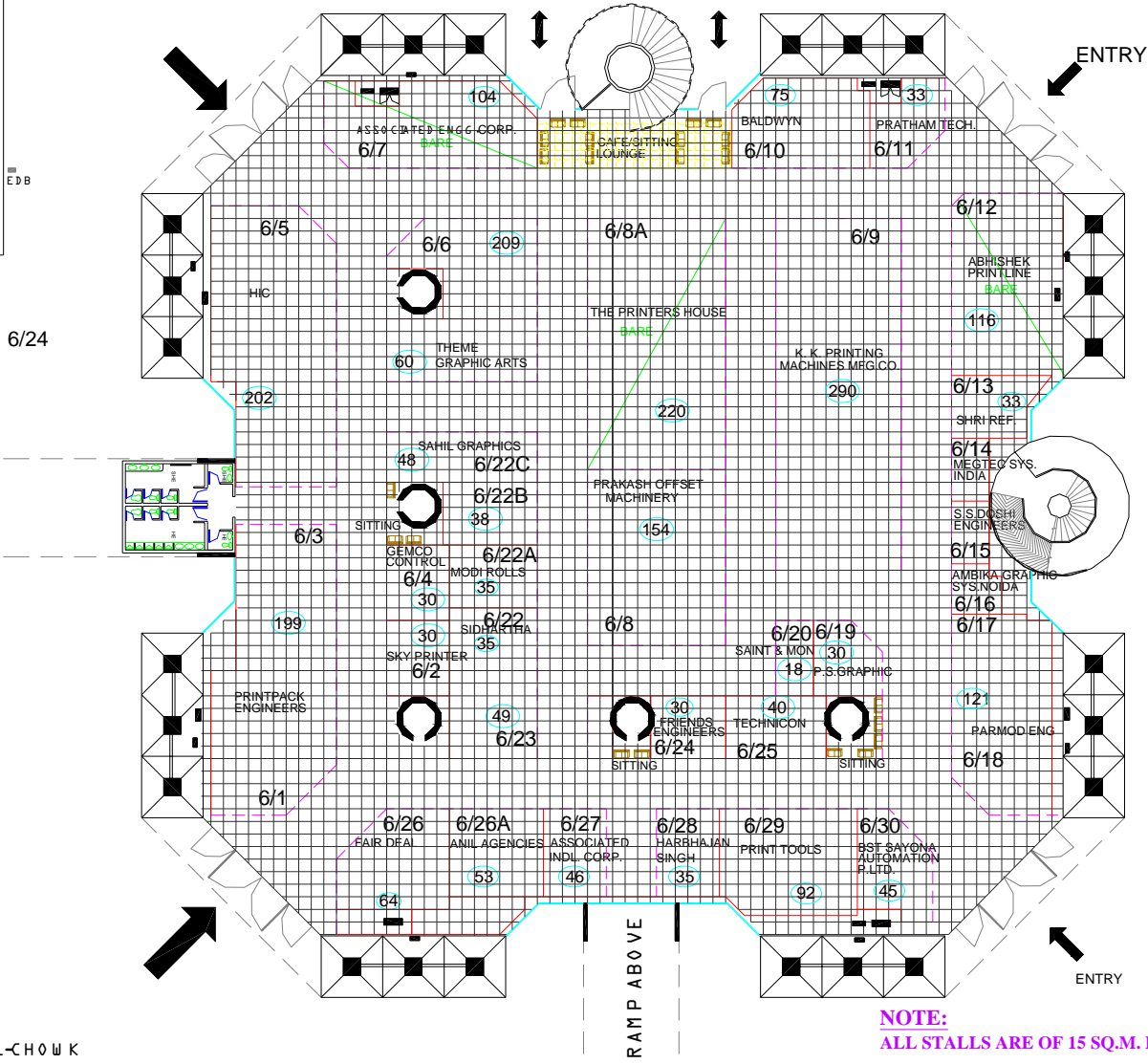

EFFICIENCY CHART:

HALL NO.	GROSS AREA (IN SQ.M.)	STALL AREA (IN SQ.M.)	EFFICIENCY
HALL 6	4415.34 SQ.M.	2511.05 SQ.M.	67%

NOTE:
ALL STALLS ARE OF 15 SQ.M. EXCEPT OTHERWISE MENTIONED.

9th PRINTPACK INDIA' 2009

HALL -7

JANUARY 18 - 23, 2009.

EFFICIENCY CHART:

HALL NO.	GROSS AREA (IN SQ.M.)	STALL AREA (IN SQ.M.)	EFFICIENCY
HALL 7ABC	2440.88SQ.M.	1276.00SQ.M.	52.27%
HALL 7D	715.88SQ.M.	350.00SQ.M.	48.90%
HALL 7E	715.88SQ.M.	362.00SQ.M.	50.60%
HALL 7FGH	2356.55SQ.M.	1206.00SQ.M.	51.17%
TOTAL AREA	6229.19SQ.M.	3194.00SQ.M.	51.27%

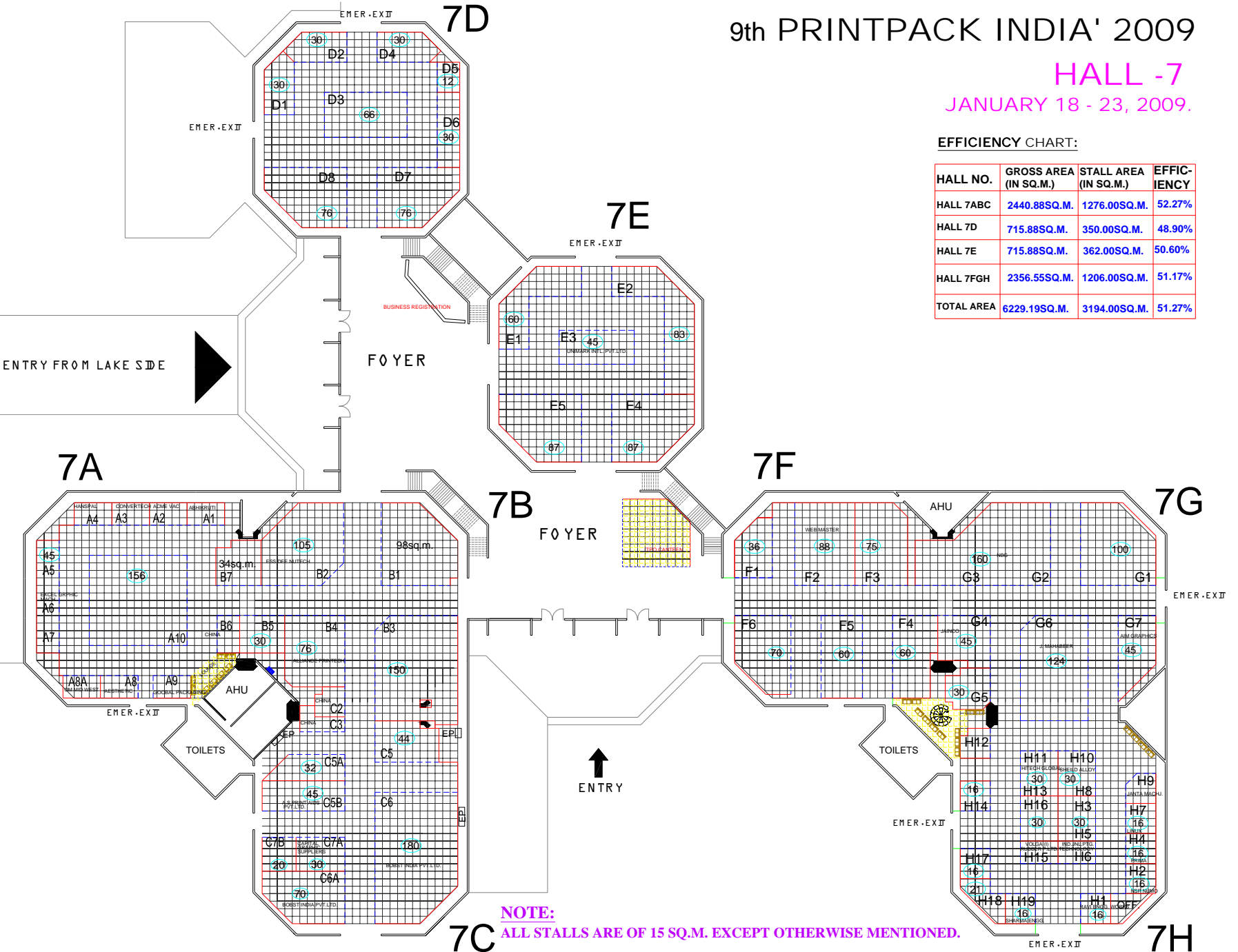

NOTE: ALL STALLS ARE OF 15 SQ.M. EXCEPT OTHERWISE MENTIONED.

9thPRINTPACK INDIA' 2009

HALL NO.- 12 & 12A
JANUARY 18 - 23, 2009.

EFFICIENCY CHART:

HALL NO.	GROSS AREA (IN SQ.M.)	STALL AREA (IN SQ.M.)	EFFICIENCY
HALL12	1681.00SQ.M.	922.00SQ.M.	54%
HALL 12A	4633.00SQ.M.	2565.00SQ.M.	59.4%
TOTAL AREA	6314.00SQ.M.	3487.00SQ.M.	55.23%

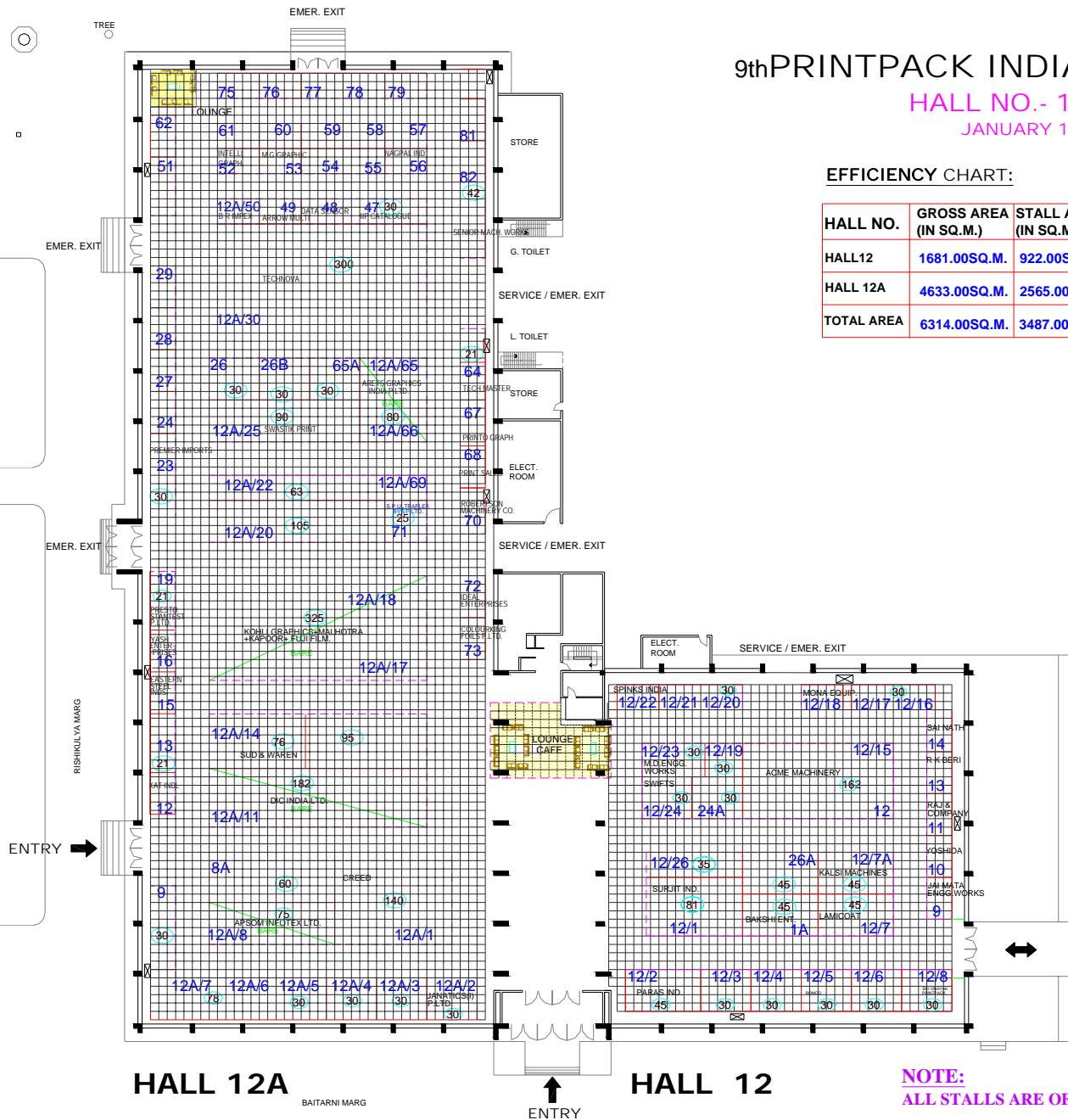

HALL 12A

BAITARNI MARG

HALL 12

NOTE:

ALL STALLS ARE OF 15 SQ.M. EXCEPT OTHERWISE MENTIONED.

